

Detalhe Recpção Pav. Superior  
Esc:1/50

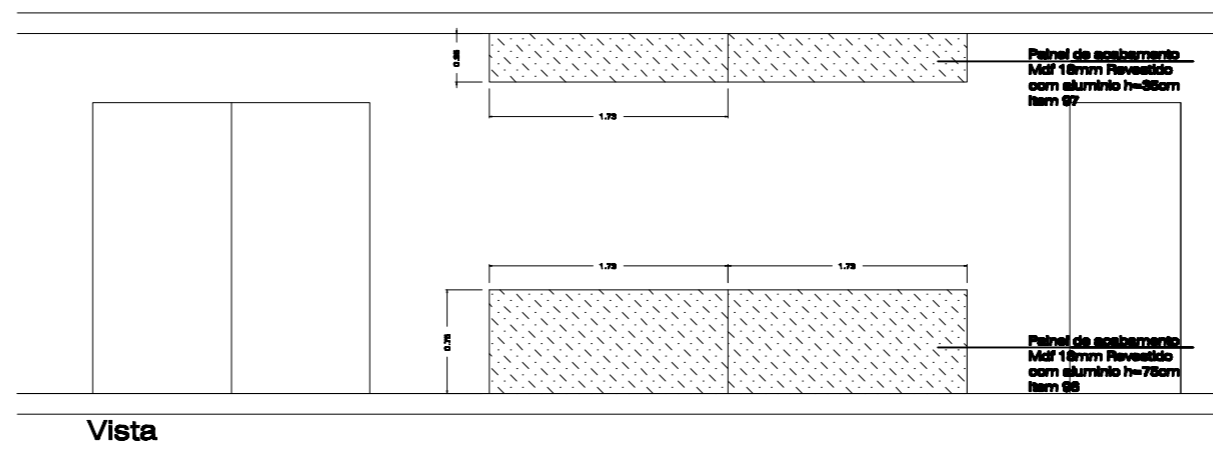

Vista

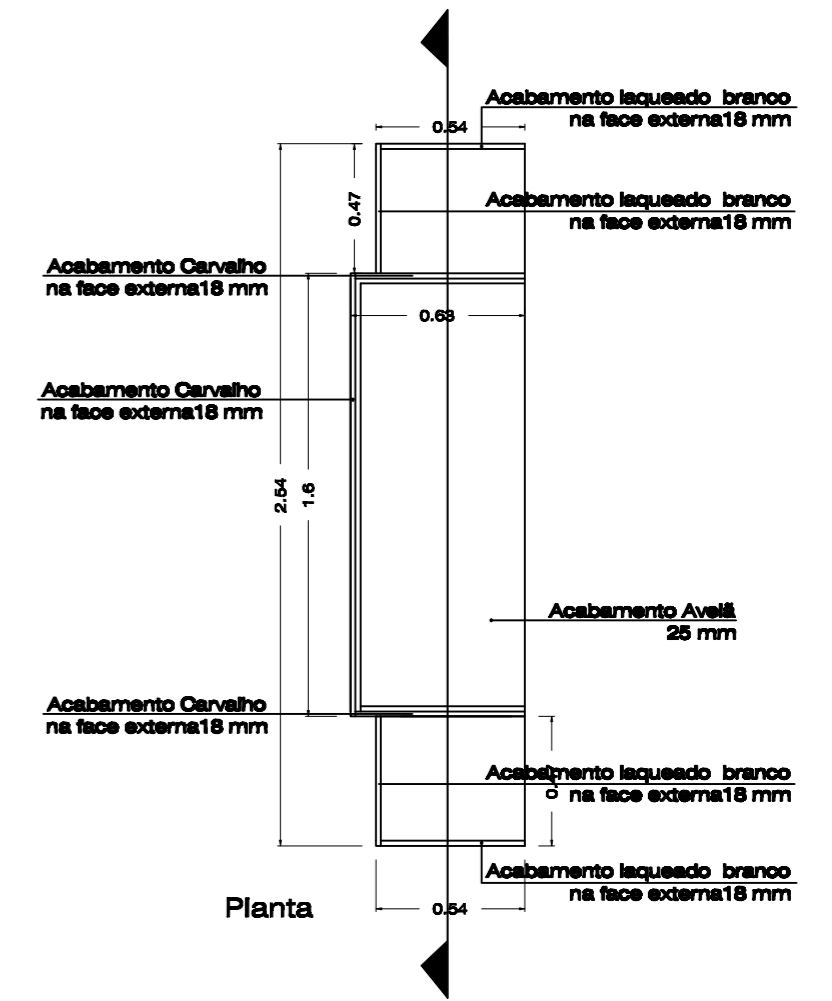

Planta

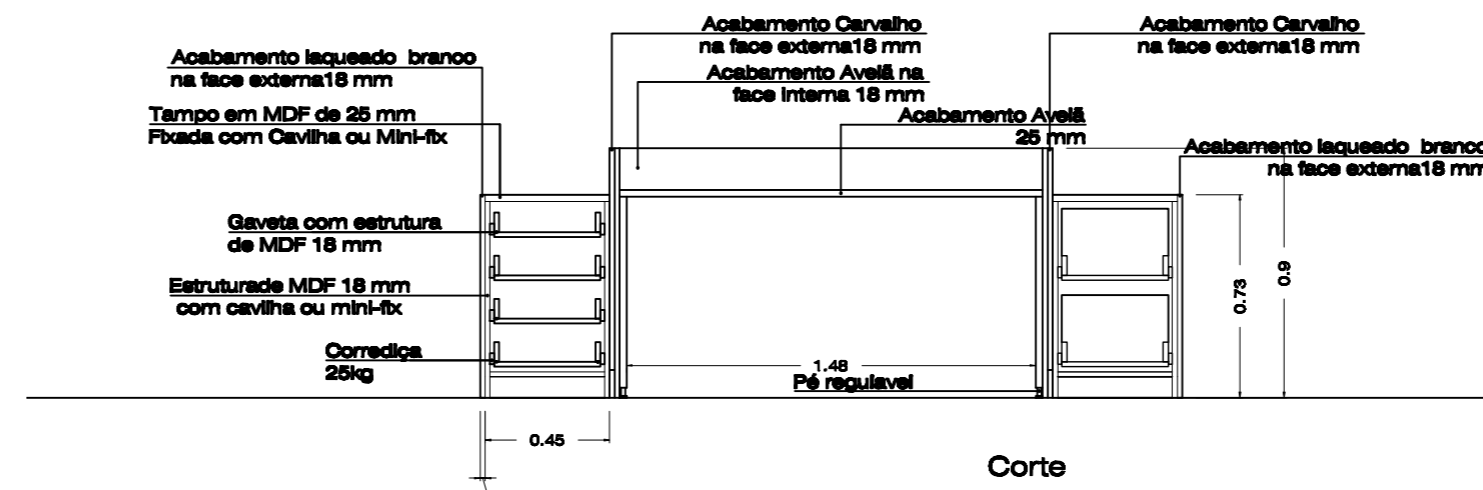

Corte

Detalhe Item 47 – Balcão da recepção superior

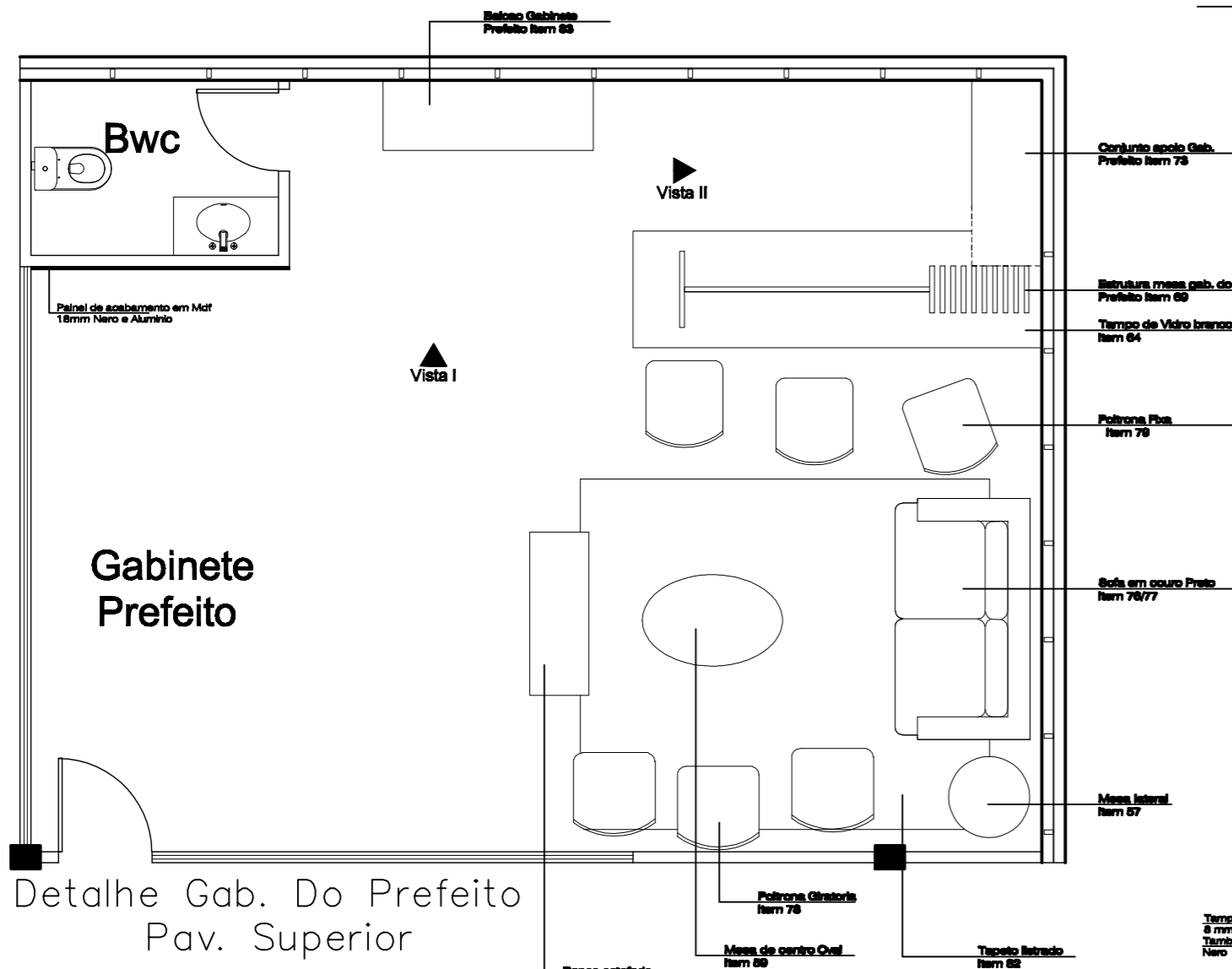

Detalhe Gab. Do Prefeito Pav. Superior  
Esc:1/50

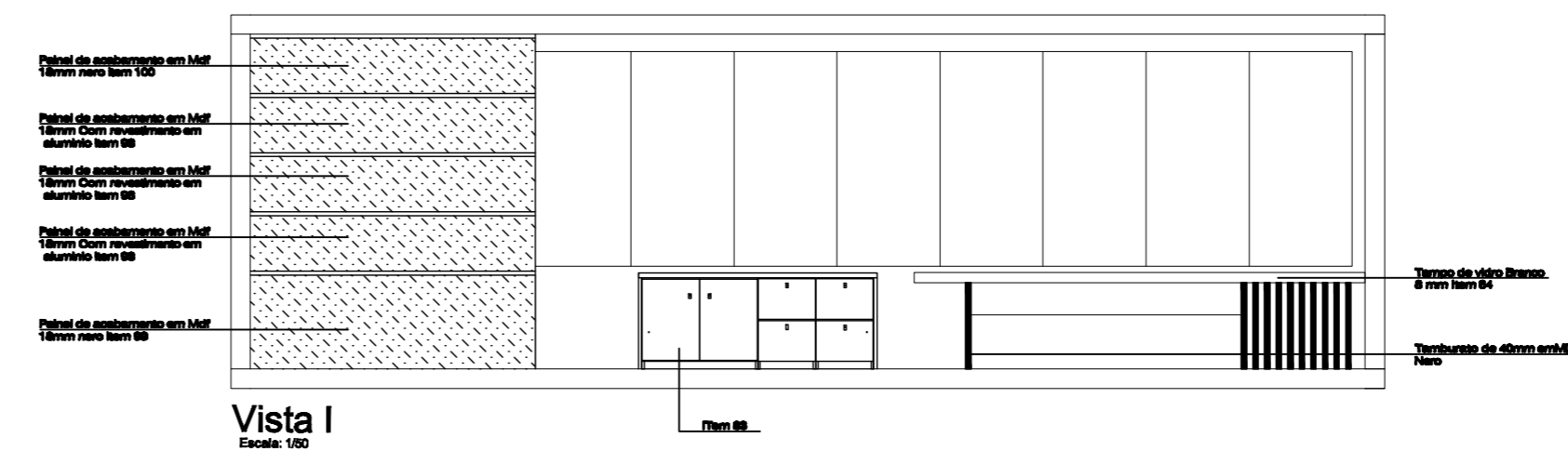

Vista I  
Escala: 1/50

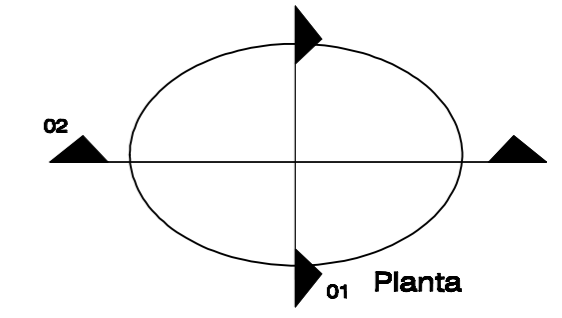

Planta

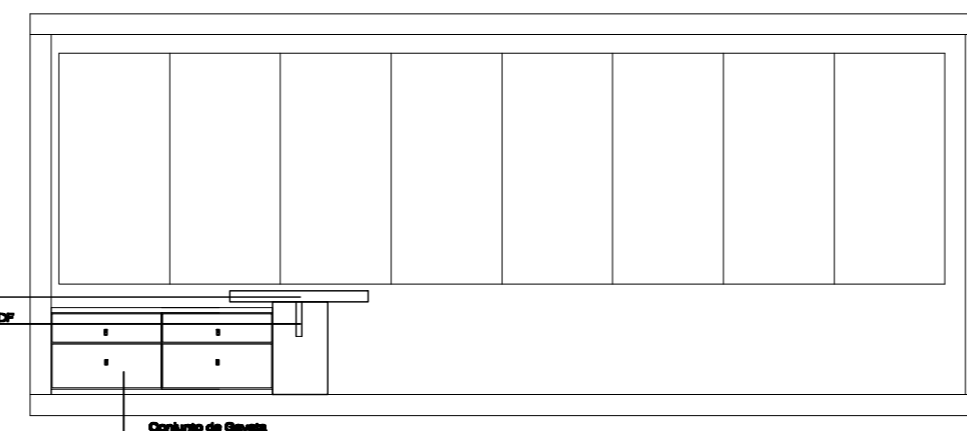

Vista II  
Escala: 1/50

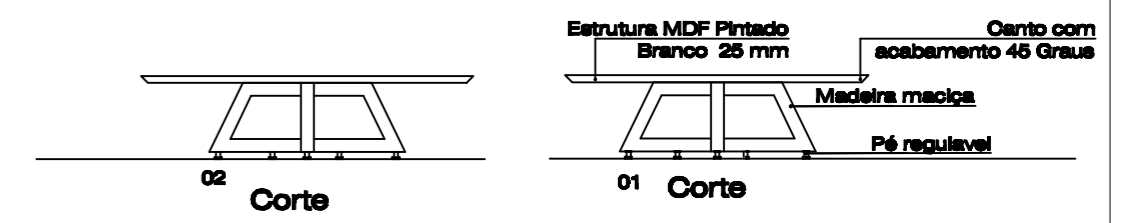

Detalhe Item 52 – Mesa Vice Prefeito

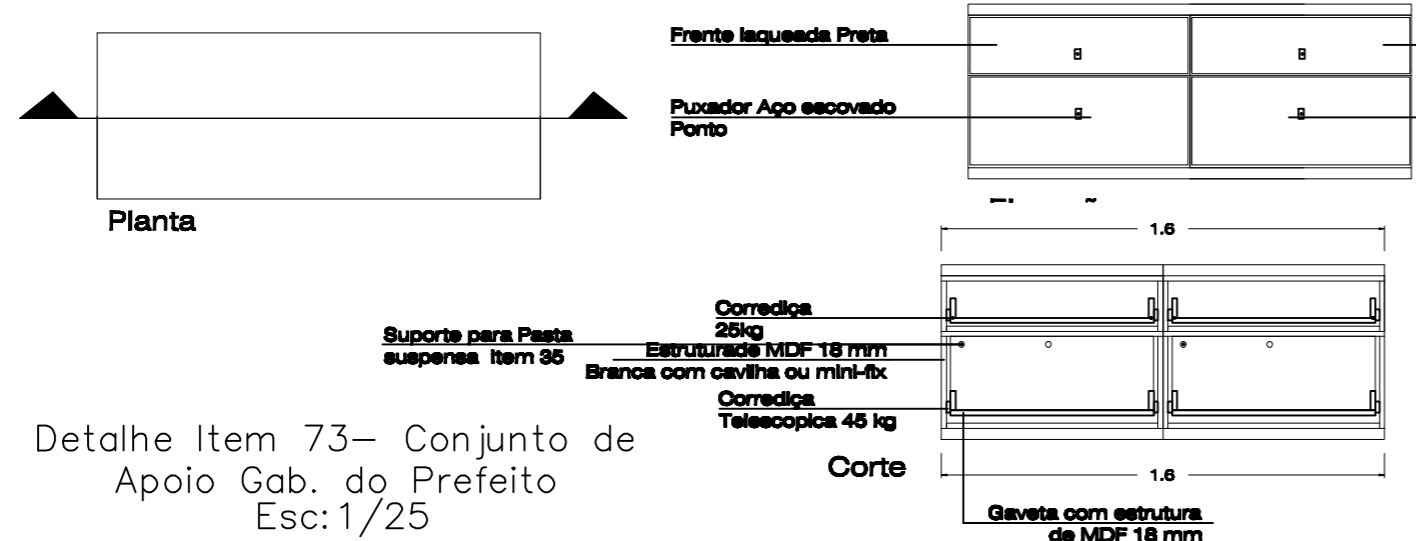

Detalhe Item 73- Conjunto de Apoio Gab. do Prefeito  
Esc:1/25

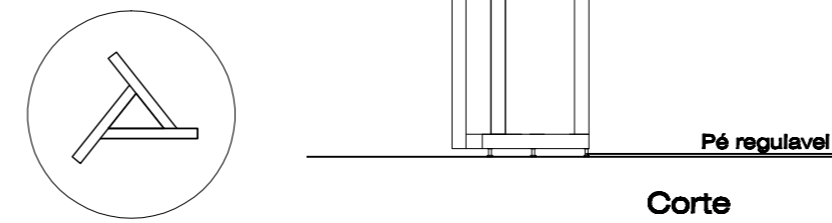

Detalhe Item 57 – Mesa lateral  
Esc:1/25

ALTERAÇÃO	DATA	RESPONSÁVEL
<p><b>PREFEITURA MUNICIPAL DE CAMPOS NOVOS SC</b>                  RUA EXPEDICIONÁRIO, 323 - CENTRO - FONE (0**49) 3541-6200 www.camposnovos.sc.gov.br  <b>SECRETARIA MUNICIPAL DE TRANSPORTES, OBRAS E URBANISMO</b>                  DEPARTAMENTO DE ENGENHARIA</p>		
<p>OBRA: <b>REFORMA PREFEITURA</b></p>		
<p>ASSUNTO: <b>MOBILIÁRIO INTERNO - DETALHES</b></p>		
DATA: <b>OUTUBRO/2011</b>	LOCAL: <b>RUA EXPEDICIONÁRIO, 323 CENTRO</b>	
ESCALA CAD: <b>INDICADA</b>	RESP. PROJETO:	
<p>FOLHA: <b>05-12</b></p> <p><b>ANA PAULA BANGHERS</b>                  CREA - SC 068188                  ARQUITETA E URBANISTA</p>		

PRODUCED BY AN AUTODESK EDUCATIONAL PRODUCT

PRODUCED BY AN AUTODESK EDUCATIONAL PRODUCT